

Adding a user

You can register up to 50 users; over 50, the PRG LED will flash quickly and any additional users will not be saved.

1 Keep pressed the PROG button on the control board. The LED flashes quickly.

2 Press any key on the transmitter you want to memorize. The LED stays on to indicate that the saving is complete.

Release the PROG button. Repeat the procedure for adding additional users. Dip-switch 4 must be set to OFF.

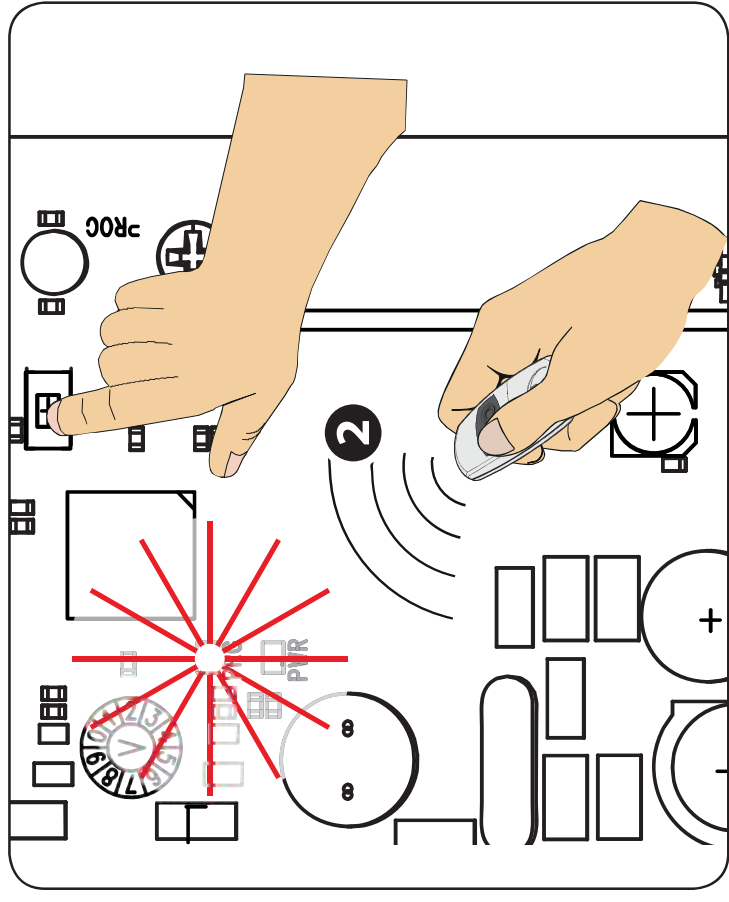
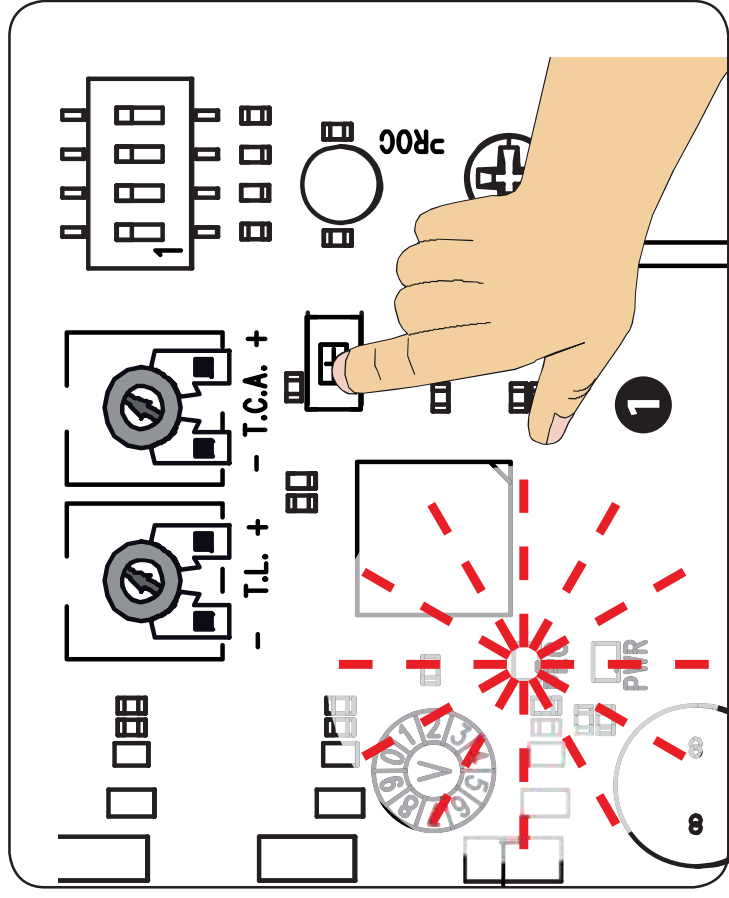

Deleting single users that have been previously saved.

Set DIP-switch 4 to ON.

- 1 Keep pressed the PROG button on the control board. The programming LED flashes.
- 2 Within five seconds, press the button on the transmitter of the user you wish to delete. The LED will flash quickly for one second to signal that the user has been deleted, and then it will switch off.

Reset DIP-switch 4 to OFF.

